



**NIPPON
PAINT**

BODELAC
High Gloss Enamel

Nippon Paint Bodelac enamel is an alkyd synthetic enamel. It has no added lead or chrome compounds, thus making it safe. It has excellent gloss retention and is suitable for a wide variety of interior and exterior metal, wood and masonry surfaces.

GREEN ASSURED



PRODUCT FEATURES



Lead Free

Paints that does not contain heavy metals are safe to use at home and environment friendly too.



High Gloss / Sheen

Gives a luxurious appearance to the surface and looks fresh & new for ever.





NIPPON PAINT

BODELAC

High Gloss Enamel

TECHNICAL DETAILS

Bases	: Base 4, Base3, Base1 and Direct colours
Colour Range	: Please refer to Nippon Paint shade card and fan decks
Finish	: High Gloss finish
Dry Time	: To Touch: -3-4 Hours To Recoat: 8-10 Hours
Gloss level	: 60° head, above 75 units
Clean up solvent	: Mineral turpentine / general purpose thinner
Stability of diluted paint	: 24 Hours
Shelf life	: 3 Years from the date of manufacture in original tightly closed containers .
Dilution	: 10% by volume with mineral turpentine or general purpose thinner.

Coverage:



BODELAC

17.65 - 19.51 sq.mt./litre/coat &
9.29 - 10.22 sq.mt./litre/2 coats

(Actual coverage is dependant on the substrate condition, surface porosity, method of application.)

HOW TO APPLY

Surface Preparation:



Remove flakes of old paint or powdery residues by sanding using an emery paper. Surface must be free from dirt, grease, oil and other foreign substances

Application:

Brush:	Dilute the paint upto 10% by volume using Mineral turpentine / general purpose thinner
Roller:	Dilute the paint upto 20% by volume using Mineral turpentine / general purpose thinner (may cause gloss reduction)
Conventional Spray:	Dilute that paint upto 15-20 % by volume using Mineral turpentine / general purpose thinner

Process:

For Exterior Surfaces

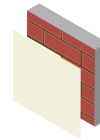

Primer

Nippon Paint Multi Purpose Solvent Primer or Nippon Paint Red Oxide Metal primer



Apply 1 coat



Allow it to dry for overnight

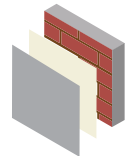

Top Coat

Nippon Paint Bodelac

Apply 2-3 coats

Allow it to dry for 16 hours

SAFETY AND ENVIRONMENT

During Painting:

Always work in a well ventilated area. Wear appropriate attire, especially gloves and eye protection gear. Avoid contact with skin as it may cause irritation.

Cleaning:

Wash all the tools with Mineral Turpentine or General Purpose Thinner.

Safety Instructions:

In the case of eye contact, rinse immediately with water and seek immediate medical treatment. To remove paint from skin, use soap and water or appropriate cleanser. In the event of spillage, contain and collect spilt paint by using sand or earth.

Precautions:

Avoid painting when the temperature is below 10°C. Painting is not recommended if the moisture content and alkalinity of the walls is high. Moisture content of the walls should be below 16% (measured by Protimeter) and alkalinity of the wall should be below pH-9. Relative humidity should be below 85%. Painting on a newly plastered wall is recommended after 12 weeks of curing.

Note: Do not Keep unpainted for more than 15 days.

For highly affected areas by Efflorescence two coats of Dr. Bond Efflorescence Resistant sealer are recommended followed by topcoats.

Storage:

Store paint in a cool, dry and well ventilated place away from heat sources, flammables or direct sunlight. Keep container tightly closed in a secure, upright position. Do not store near food, drink or animal feed. Keep out of reach of children. Do not dispose of unwanted paint into drains, water sources or open sewers. To dispose safely, pour unwanted paint onto old newspapers and let dry before placing in a proper waste receptacle

Disposal Information:

Disposal of any paint waste & containers in accordance with applicable Environment (Protection) Act 1986 under the Hazardous Wastes (Management & Handling) rules 1989.

Environment:

Does not contain any added lead, mercury or chromium compounds.

Lead content does not exceed 90 parts per million.

