



NIPPON PAINT

ROOF COATING EMULSION

High-gloss

Nippon Paint Roof Coating is an acrylic paint that is specially formulated for painting and re-painting asbestos and roof tiles. It is easy to apply and forms a smooth, tough film, which is durable, fungus-resistant and has excellent gloss and low dirt - collection.

GREEN ASSURED



PRODUCT FEATURES



Water Repellent

Beautiful looking exteriors for long.



High Sheen

Gives rich luxurious look and feel to the tiles/roofs.



Low VOC

Environment-friendly and healthy paint.

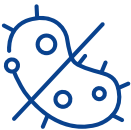

Anti Algal

The roof looks rich and spotless for longer.

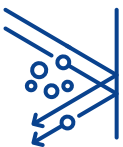

Dirt Pick-up Resistant

Tiles look new and beautiful for years.





NIPPON PAINT

ROOF COATING EMULSION

High-gloss

TECHNICAL DETAILS

Bases	:	Direct shades & RC1 Base.
Colour Range	:	Please refer to Nippon Paint shade card and fan decks
Finish	:	High Sheen Finish
Dry Time	:	To Touch: 30 minutes To Recoat: 4-6 Hours
Gloss level	:	60° head: 12 to 20 units
Clean up solvent	:	Clean, potable water
Stability of diluted paint	:	24 Hours
Shelf life	:	3 Years from the date of manufacture in original tightly closed containers
Dilution	:	Ready to use. If required, dilute with 5% potable Water

Coverage:



ROOF COATING

100 - 120 sq ft/litre/coat
& 50 - 60 sq ft/litre/2 coats

(Actual coverage is dependant on the substrate condition, surface porosity, method of application)

HOW TO APPLY

Surface Preparation:

For Repainting: Clean the surface till it is free from dust, grease and flaking paint. Any unstable paint to be removed, using high-pressure wash or scraper, whichever is appropriate. Algae and fungus on the roof tiles to be removed, by using high-pressure wash or coir brush and shall be treated with Walltron Kleanwall Fungicidal solution.

New Surface: Ensure surface is completely cured and dry. Application of cement paint/lime/Cement putty as undercoat is not recommended. Fill the cracks upto 3mm if any with Walltron N-seal crack fill powder.

Process:

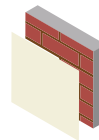

Top Coat
Nippon Paint
Roof Coat

Apply 2-3 coats

Allow it to dry for 4-6 hours

For repainting and chalky surface use Dr. Bond Efflorescence Resistant Sealer by diluting 100% by volume with clean potable water before applying topcoats.

Application:

Brush: Dilute both 1st and 2nd coats with 5% water

Roller: Dilute both 1st and 2nd coats with 5% water

SAFETY AND ENVIRONMENT

During Painting:

Always work in a well ventilated area. Wear appropriate attire, especially gloves and eye protection gear. Avoid contact with skin as it may cause irritation.

Cleaning:

Clean all equipments with clean water immediately after use.

Safety Instructions:

In the case of eye contact, rinse immediately with water and seek immediate medical treatment. To remove paint from skin, use soap and water or appropriate cleanser. In the event of spillage, contain and collect spilt paint by using sand or earth.

Precautions:

Avoid painting when the temperature is below 10°C. Painting is not recommended if the moisture content and alkalinity of the Rooftiles is high. Moisture content of the rooftiles should be below 16% (measured by Protimeter) and alkalinity of the rooftiles should be below pH-9. Relative humidity should be below 85%.

Storage:

Store paint in a cool, dry and well ventilated place away from heat sources, flammables or direct sunlight. Keep container tightly closed in a secure, upright position. Do not store near food, drink or animal feed. Keep out of reach of children. Do not dispose of unwanted paint into drains, water sources or open sewers. To dispose safely, pour unwanted paint onto old newspapers and let dry before placing in a proper waste receptacle.

Disposal Information:

Disposal of any paint waste & containers in accordance with applicable Environment (Protection) Act 1986 under the Hazardous Wastes (Management & Handling) rules 1989.

Environment:

Does not contain any added lead, mercury or chromium compounds.
Lead content does not exceed 90 parts per million.

Note: Note: Horizontal surface, one or two additional coats are recommended for better performance of paint film.

